

Features

- Ultra low leakage: nA level
- Operating voltage: 5V
- Low clamping voltage
- Complies with following standards:
 - IEC 61000-4-2 (ESD) immunity test
 - Air discharge: $\pm 25\text{kV}$
 - Contact discharge: $\pm 20\text{kV}$
 - IEC61000-4-4 (EFT) 40A (5/50ns)
 - IEC61000-4-5 (Lightning) 5A (8/20 μs)
- RoHS Compliant

Applications

- USB Ports
- SIM Ports
- Smart Phones
- Wireless Systems
- Set-top box and digital TV
- Digital video interface (DVI)
- Ethernet 10/100/1000 Base T

Mechanical Characteristics

- Package: SOT-23
- Lead Finish: Lead Free
- UL Flammability Classification Rating 94V-0
- Quantity Per Reel: 3,000pcs
- Reel Size: 7 inch
- Device Marking: 5M

Absolute Maximum Ratings (Tamb=25°C unless otherwise specified)

| Parameter | Symbol | Value | Unit |
|--|------------------|-------------|------|
| Peak Pulse Power (8/20 μs) | Ppp | 80 | W |
| ESD per IEC 61000-4-2 (Air) | V _{ESD} | ± 25 | kV |
| ESD per IEC 61000-4-2 (Contact) | | ± 20 | |
| Operating Temperature Range | T _J | -55 to +125 | °C |
| Storage Temperature Range | T _{STJ} | -55 to +150 | °C |

Dimensions SOT-23

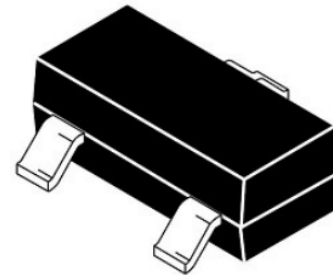

Pin Configuration

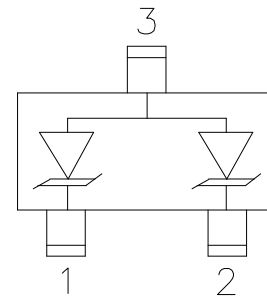

Electrical Characteristics (TA=25°C unless otherwise specified)

| Parameter | Symbol | Min | Typ | Max | Unit | Test Condition |
|-------------------------|--------|-----|------|-----|------|--|
| Reverse Working Voltage | VRWM | | | 5 | V | Pin 1 or pin 2 to pin 3 and between pin 1 and pin 2 |
| Breakdown Voltage | VBR | 6 | | | V | IT = 1mA, pin 1 or pin 2 to pin 3 and between pin 1 and pin 2 |
| Reverse Leakage Current | IR | | 0.01 | 0.5 | μA | VRWM = 5V, Pin 1 or pin 2 to pin 3 and between pin 1 and pin 2 |
| Clamping Voltage | VC | | | 9 | V | I _{PP} = 1A (8 x 20μs pulse), pin 1 or pin 2 to pin 3 |
| Clamping Voltage | VC | | | 16 | V | I _{PP} = 5A (8 x 20μs pulse), pin 1 or pin 2 to pin 3 |
| Junction Capacitance | CJ | | 0.3 | 0.4 | pF | VR = 0V, f = 1MHz, between pin 1 and pin 2 |
| Junction Capacitance | CJ | | | 0.8 | pF | VR = 0V, f = 1MHz, pin 1 or pin 2 to pin 3 |

Typical Performance Characteristics(TA=25°C unless otherwise specified)

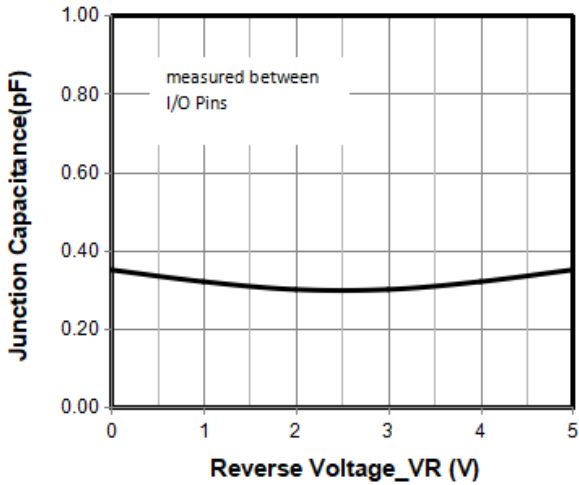

Junction Capacitance vs. Reverse Voltage

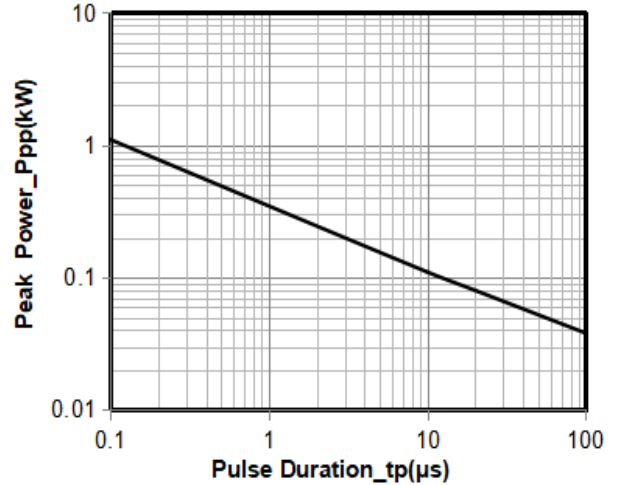

Peak Pulse Power vs. Pulse Time

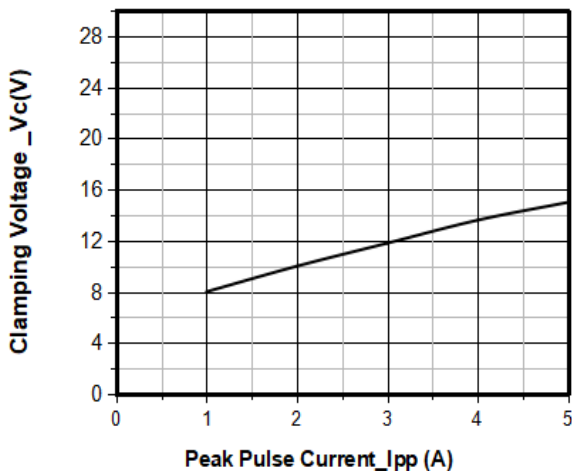

Clamping Voltage vs. Peak Pulse Current

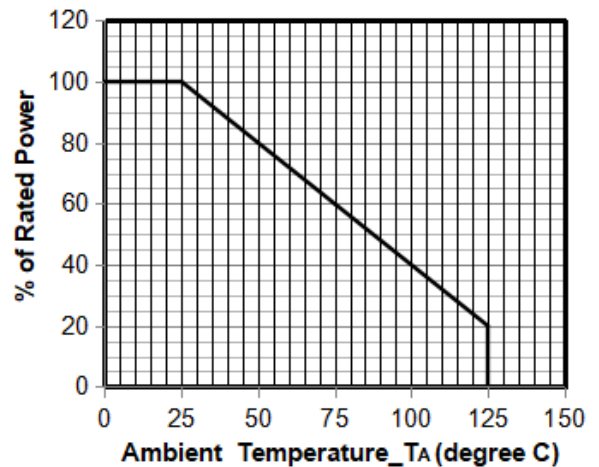

Power Derating Curve

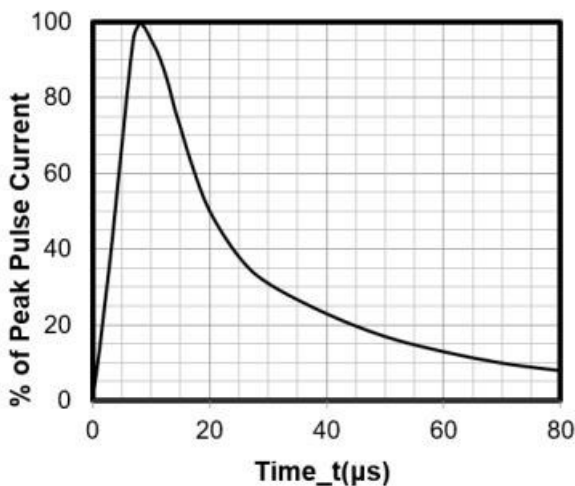

8 X 20μs Pulse Waveform

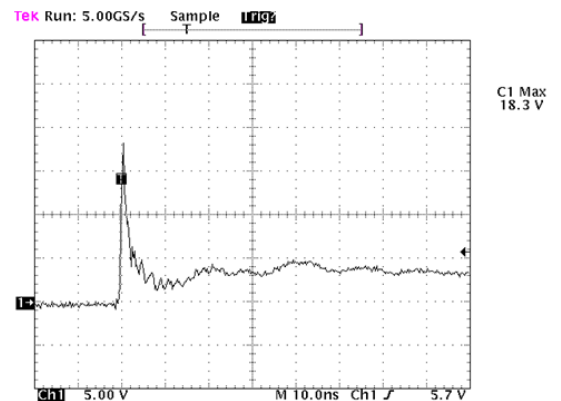

Note: Data is taken with a 10x attenuator

ESD Clamping Voltage

8 kV Contact per IEC61000-4-2

SOT-23 Package Outline Drawing

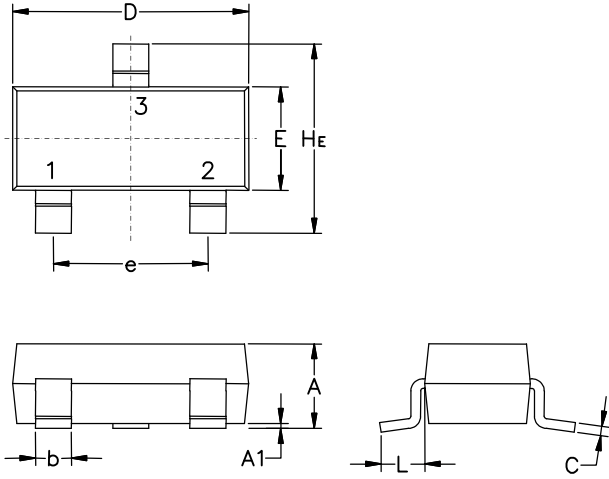

| Symbol | Millimeters | | | Inches | | |
|----------------|-------------|------|------|--------|-------|-------|
| | Min. | Nom. | Max. | Min. | Nom. | Max. |
| A | 0.89 | 1.00 | 1.11 | 0.035 | 0.040 | 0.044 |
| A1 | 0.01 | 0.06 | 0.10 | 0.001 | 0.002 | 0.004 |
| b | 0.37 | 0.44 | 0.50 | 0.15 | 0.18 | 0.020 |
| c | 0.09 | 0.13 | 0.18 | 0.003 | 0.005 | 0.007 |
| D | 2.80 | 2.90 | 3.04 | 0.110 | 0.114 | 0.120 |
| E | 1.20 | 1.30 | 1.40 | 0.047 | 0.051 | 0.055 |
| e | 1.78 | 1.90 | 2.04 | 0.070 | 0.075 | 0.081 |
| L | 0.35 | 0.54 | 0.69 | 0.014 | 0.021 | 0.029 |
| H _E | 2.10 | 2.40 | 2.64 | 0.083 | 0.094 | 0.104 |

Suggested Land Pattern

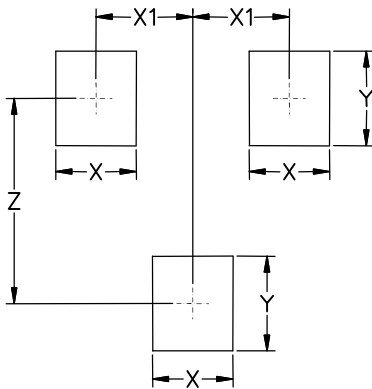

| Symbol | Millimeters | Inches |
|--------|-------------|--------|
| X | 0.80 | 0.031 |
| X1 | 0.95 | 0.037 |
| Y | 0.90 | 0.035 |
| Z | 2.00 | 0.079 |

NOTICE

Leiditech reserves the right to make modifications, enhancements, improvements, corrections or other changes without further notice to any product herein. Leiditech does not assume any liability arising out of the application or use of any product described herein.